

# Poly CCX 500 Business Media Phone

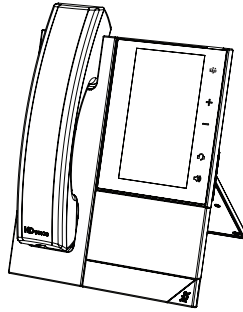

## Package Contents

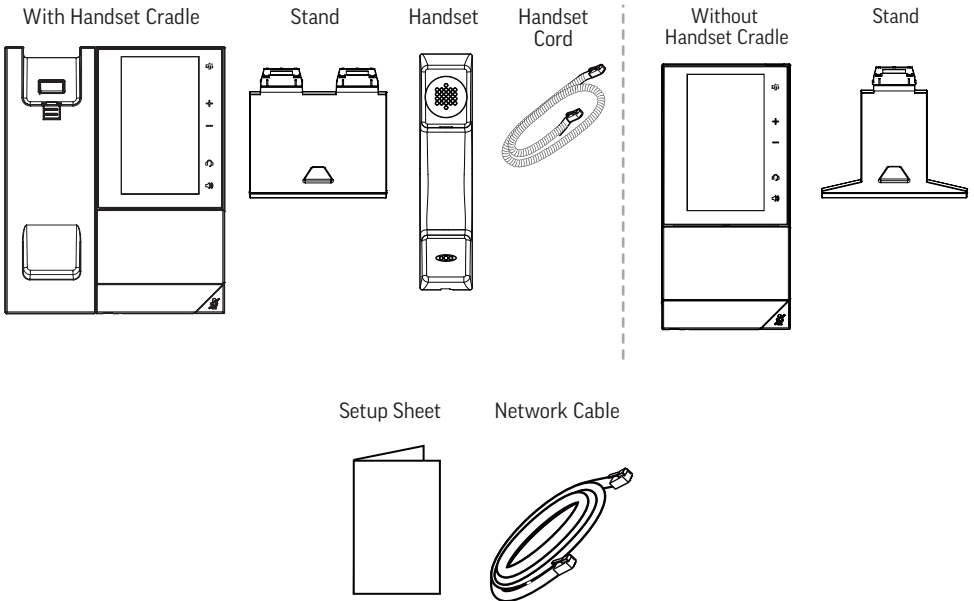

## Optional Accessories



AC Power Adapter  
(varies by region)

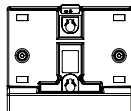

Wallmount

# Features

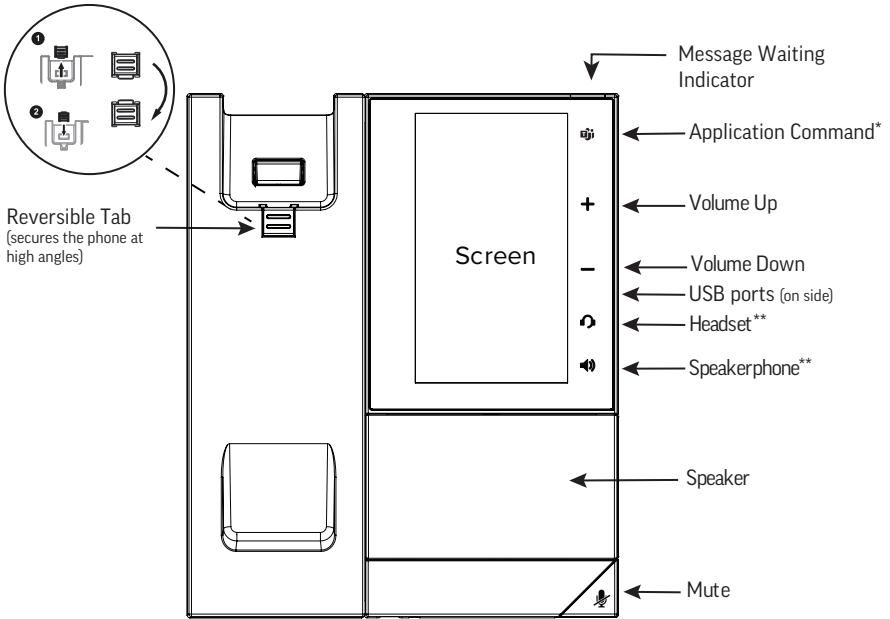

\*Icon displays only when the phone is powered on and the service is available. Icon may vary.

\*\* Icon displays when the phone is powered on.

# Connect Desktop Stand

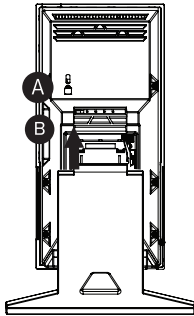

A

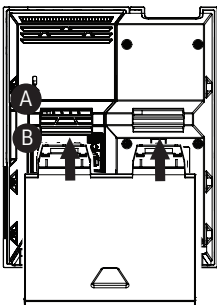
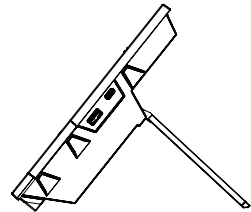

B

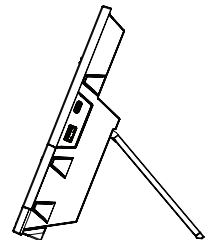

# Connect Cables

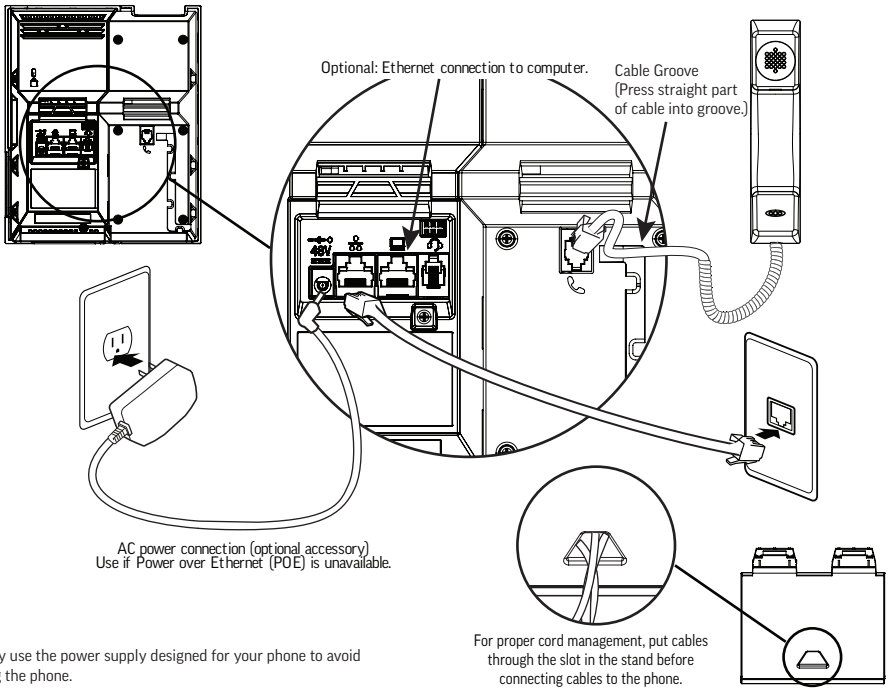

# Connect Optional Headset

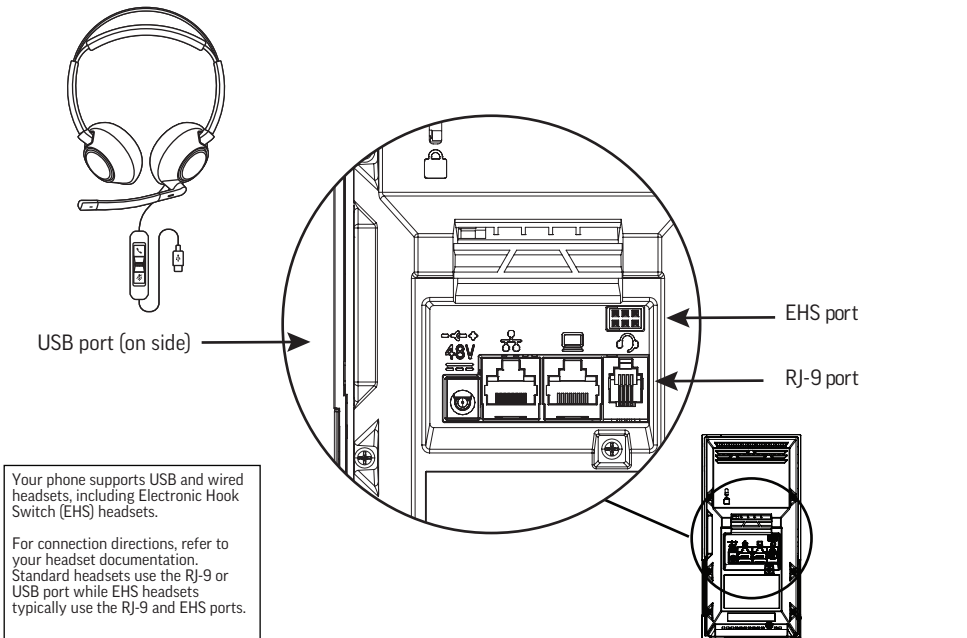



BY USING THIS PRODUCT, YOU ARE AGREEING TO THE TERMS OF THE END USER LICENSE AGREEMENT (EULA) AT:

<http://documents.polycom.com/indexes/licenses>. IF YOU DO NOT AGREE TO THE TERMS OF THE EULA, DO NOT USE THE PRODUCT, AND YOU MAY RETURN IT IN THE ORIGINAL PACKAGING TO THE SELLER FROM WHOM YOU PURCHASED THE PRODUCT.

Refer to the Limited Warranty section of the Product Warranty Guide found in Services at <http://support.polycom.com/>

---

Hereby, Poly declares that the radio equipment type CCX 500 is in compliance with Directive 2014/53/EU. The full text of the EU declaration of conformity is available at [typeapproval@polycom.com](mailto:typeapproval@polycom.com).

Frequency Range	Maximum Transmit Power
2402-2480MHz	9.26 dBm

**Polycom Documentation**  
[www.polycom.com/support](http://www.polycom.com/support)



**ENERGY STAR®:**



Backlight intensity and timeout can be adjusted in basic user settings menu. By default, after the phone is idle for 40 seconds, the backlight dims. The backlight automatically turns on with any phone activity.

---

© 2019 Plantronics, Inc. All rights reserved. Poly, the propeller design, and the Poly logo are trademarks of Plantronics, Inc. All other trademarks are the property of their respective owners.

**Contact Information:**

Contact your Authorized Reseller for Assistance.  
[www.poly.com](http://www.poly.com)

Plantronics, Inc. 345 Encinal Street Santa Cruz, California 95060

1725-49715-001B



# Poly CCX 505 Business Media Phone

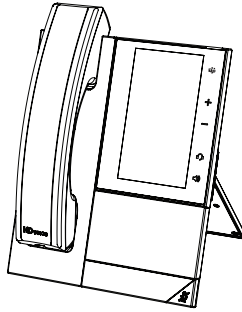

---

## Package Contents

Poly CCX 505 Phone Console

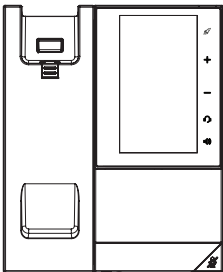

Stand

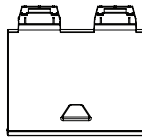

Handset

Handset  
Cord

Setup Sheet

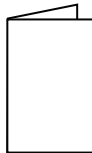

Network Cable

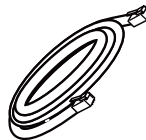

---

## Optional Accessories

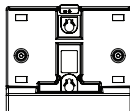
AC Power Adapter  
(varies by region)

Wallmount

# Features

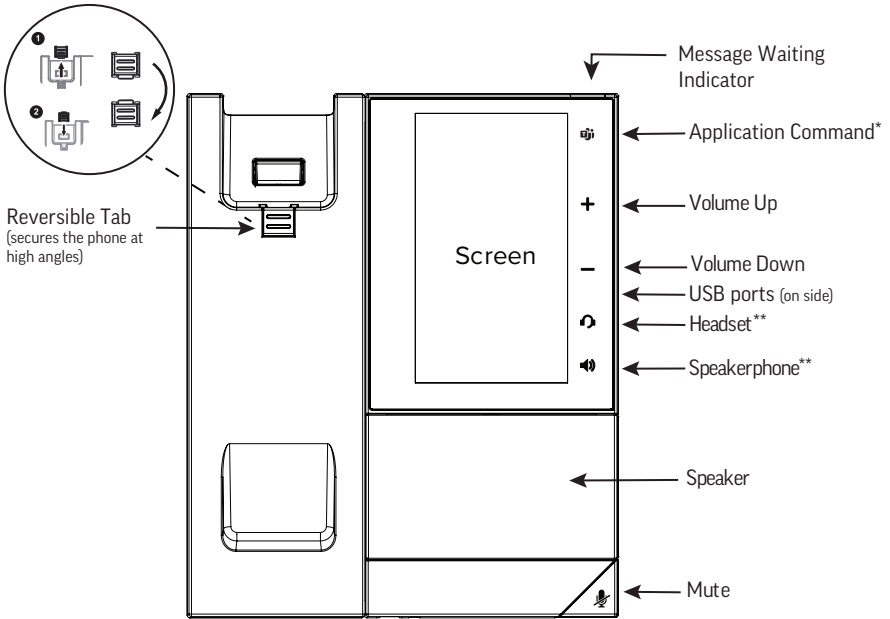

\*Icon displays only when the phone is powered on and the service is available. Icon may vary.

\*\* Icon displays when the phone is powered on.

# Connect Desktop Stand

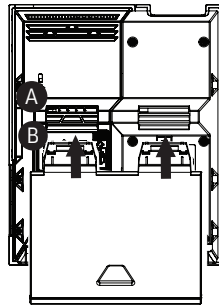

A

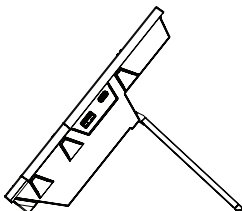

B

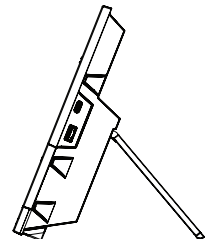

# Connect Cables

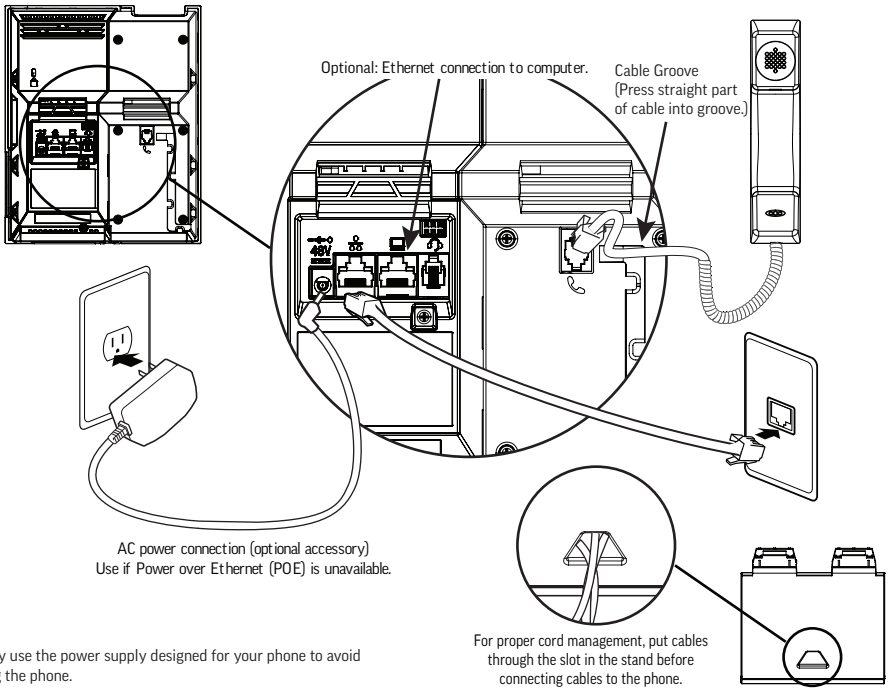

# Connect Optional Headset

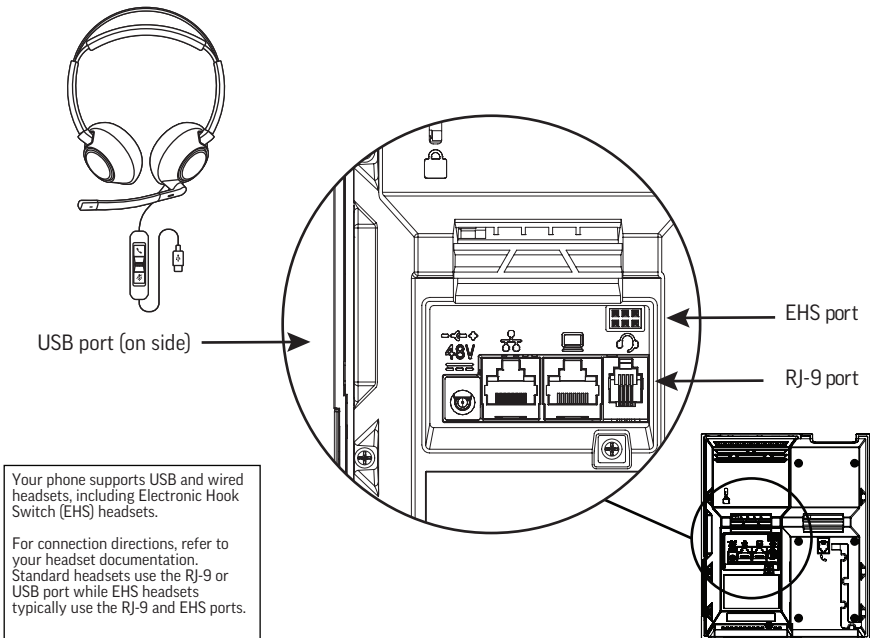



BY USING THIS PRODUCT, YOU ARE AGREEING TO THE TERMS OF THE END USER LICENSE AGREEMENT (EULA) AT: POLY END USER LICENSE AGREEMENT. IF YOU DO NOT AGREE TO THE TERMS OF THE EULA, DO NOT USE THE PRODUCT, AND YOU MAY RETURN IT IN THE ORIGINAL PACKAGING TO THE SELLER FROM WHOM YOU PURCHASED THE PRODUCT.

Refer to the Warranty information found at [poly.com/support/ccx-505](http://poly.com/support/ccx-505).

## CCX 505

Frequency Range	Maximum Transmit Power	Source
2402 MHz–2480 MHz	8.26 dBm	Bluetooth™ EDR
2402 MHz–2480 MHz	6.51 dBm	Bluetooth™ LE
2412 MHz–2472 MHz	16.30 dBm	2.4G WLAN
5180 MHz–5240 MHz	16.57 dBm	5G Band 1 WLAN
5260 MHz–5320 MHz	16.67 dBm	5G Band 2 WLAN
5500 MHz–5700 MHz	16.62 dBm	5G Band 3 WLAN

## UKCA

UK representative: Plantronics Ltd, Building 4, Foundation Park, Cannon Lane, Part 1st Floor, Maidenhead, SL6 3UD

## EU

EU representative: Plantronics, B.V. (Netherlands), Scorpius 171, 2132 LR Hoofddorp, Netherlands

### ENERGY STAR®:



Backlight intensity and timeout can be adjusted in basic user settings menu. By default, after the phone is idle for 40 seconds, the backlight dims. The backlight automatically turns on with any phone activity.



[poly.com/support/ccx-505](http://poly.com/support/ccx-505)

© 2022 Poly. Bluetooth is a registered trademark of Bluetooth SIG, Inc. All trademarks are the property of their respective owners.

### Contact Information:

Contact your Authorized Reseller for Assistance.  
[www.poly.com](http://www.poly.com)  
Poly, 345 Encinal Street Santa Cruz, California 95060

1725-87399-001B

